

Case Study 3

Masterplan Unlocks Greenspace Potential in Barrhead

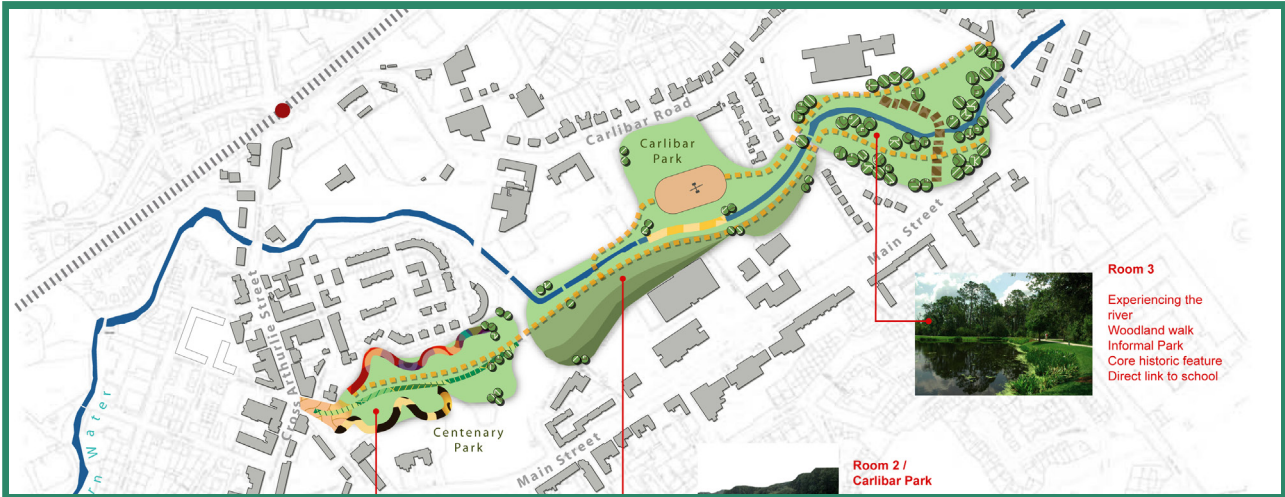

Through the ‘Better Barrhead’ initiative, East Renfrewshire Council has developed a Masterplan for the redevelopment of the town centre. This strategic blueprint places greenspace at the heart of future regeneration activity. It provides certainty on what needs to be done and an indication as to how much it will cost. This helps to inform and speed up the planning process and also assists the generation of funding packages to deliver key elements of the plan.

Context

Barrhead is a traditional industrial town on the south western edge of the greater Glasgow conurbation. Despite decades of industrial decline, it has retained a strong and active community, hosts valuable facilities and is well served by transport links to Glasgow and the surrounding areas.

Notable greenspace in the area includes Carlibar Park and Centenary Park which both include stretches of the River Leven and form a linear corridor, connecting different areas of the town.

“The masterplan sets out an exciting and ambitious plan to upgrade this very valuable greenspace feature of Barrhead’s town centre. I’m delighted that the plan puts the improvement of the environment at the heart of Barrhead’s regeneration programme.”

Councillor Tony Buchanan

Over the years, walkways, seating areas and some signage have been introduced to the parks and waterside. Despite this, it was acknowledged that the greenspace wasn’t fulfilling its potential, and that there were opportunities to improve the function and appearance of the area, and that the potential of this resource could best be realised within the Better Barrhead regeneration programme.

Project Background

Better Barrhead is a 10 year, £100m regeneration plan to create a place that meets the needs of its residents and businesses, and also of potential investors. The overall aim is to ensure a prosperous future by creating new jobs, building new facilities and creating new public places. The Masterplan builds on existing greenspace assets including local parks to provide and enhance links throughout the town centre, connecting the railway station, shops and key services.



Key Points

- The Masterplan provides strategic blueprint for how Barrhead's greenspace will be developed. This provides a level of certainty on what needs to be done and roughly how much it will cost
- Greenspace is seen as an integral element of the town centre's regeneration - not something dealt with separately or afterwards. This ensures that the overall vision is not eroded by piecemeal development
- The plan builds on existing greenspace resources, such as the Carlibar Park and Centenary Park, which provide an important green link through the town centre of Barrhead, connecting the railway station, new housing, shops, businesses and key services.
- The long term strategy also considers future developments beyond Barrhead, and through a programme of core paths creation seeks to link the linear park with Cowan Park and beyond this, into south east Glasgow to the 'Dams to Darnley Country Park'.

What it Does

With a brief provided by East Renfrewshire Council, consultants ERZ Ltd provided draft designs and ideas in consultation with the local communities, gathered during a full day's open event. Before being finalised the Masterplan was presented to Barrhead Regeneration Board for its endorsement.

The Masterplan provides a strategy for improvement, outline designs and artist's impressions for specific projects, and a cost plan.

The Masterplan is also a tool to draw in funding as it provides a realistic and tangible blueprint for the improvement of local parks. Content from the plan is presently being submitted with funding applications to a variety of bodies.

The design guidance included in the plan considers the landscape setting of key new developments in the Barrhead regeneration programme such as the Health Centre and Learning Hub. In addition, the Masterplan provides suggestions for volunteering opportunities and, given the emphasis on promoting cycling and walking, relates well to the work of the local Community Health Care Partnership.

Specifically, recommendations and projects arising from the Masterplan have dovetailed



with the objectives of Go Barrhead, a government funded pilot on reducing dependence on the car, and with the Barrhead Healthy Weight Project.

The encouragement of sustainable forms of transport such as cycling and walking also links in with the ambitions of the new £18 Million Community Health and Social Care Centre located in the town centre which seeks to use an integrated approach to improve the health of local residents.

Awarded:
Scottish Government's Town Centre
Regeneration Fund



“The masterplan will hopefully help us unlock funding to deliver these exciting projects.”

Gillian McNamara, Principal Projects and Programmes Officer

CSGN Support & Learning

The Masterplan was assisted through the CSGN Development Fund. Specifically, this enabled the expansion of the existing town centre regeneration project into the town’s green spaces - cementing the core CSGN principle that quality green space is vital to economic regeneration.

Effectively this support has enabled development work to be undertaken sooner, better and to greater detail. Nine months from the original application the on-the-ground delivery of objectives outlined in the plan was set in motion.

Future

The Masterplan has, so far, led to the creation of

a new play park, and will continue to guide and inform projects and regeneration developments throughout Barrhead and beyond the East Renfrewshire Council area.

The long term strategy outlines future developments of core paths creation to link the linear park with Cowan Park and beyond this into the Glasgow Council area, to ‘Dams to Darnley Country Park’.

When completed, the Masterplan will result in the planting of over 200 semi mature trees, 1,500 linear metres of footpath, new bridges, benches and other street furniture, landmark sculptures and features and riverside improvements.



Outcomes

Better Greenspace: A new playpark has already been delivered and the Masterplan ensures that all future regeneration activity acknowledges the importance of local greenspace

Healthier People: The Masterplan guidelines dictate that the town centre and surrounding area should be accessed by sustainable forms of transport such as cycling and walking; activities which promote a range of health promoting benefits

More Engaged Communities: Local participation in the development of the Plan has served to increase public confidence in the viability of the town centre and create local support for the regeneration activity.

Increased Funding: The Plan will act as a device to seek access to funding opportunities.

Location

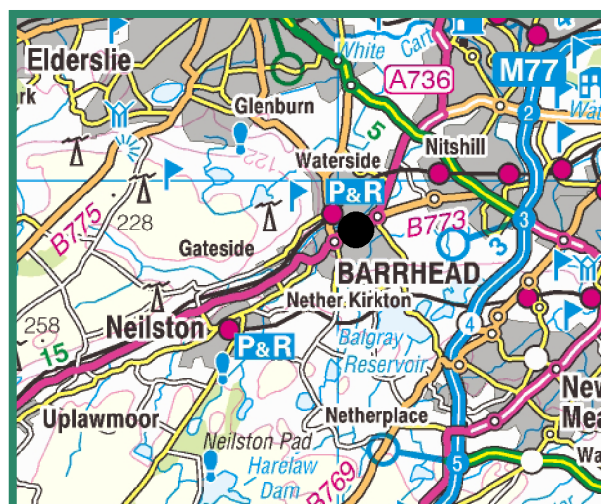
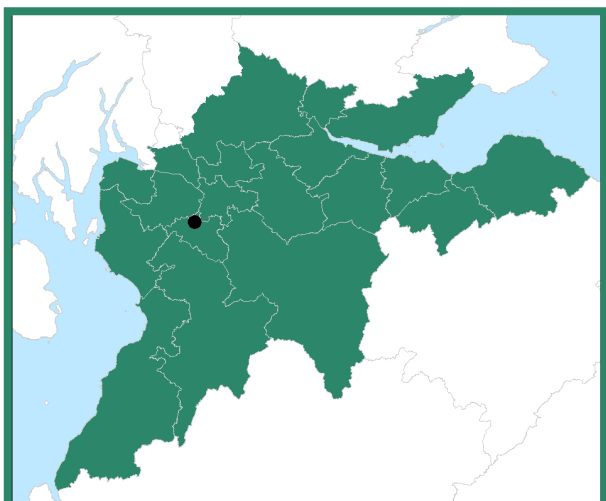

© Crown Copyright and database right 2012. All rights reserved. 100002151.

Contact

Gillian McNamara
Principal Projects and Programmes Officer
Environment Department
East Renfrewshire Council
Email: gillian.mcnamara@eastrenfrewshire.gov.uk

Project Partners

East Renfrewshire Council
ERZ Ltd

What is the CSGN?

The CSGN is a national development within the National Planning Framework which aims to make 'a significant contribution to Scotland's sustainable economic development'. It involves public agencies and stakeholders (those with an interest in our work) working together to align their policies, programmes and actions to achieve a common aim. That aim is to change the face of Central Scotland by restoring and improving the rural and urban landscape of the area.

Getting in Touch

To discuss this case study please contact: Stephen Hughes, Monitoring & Evaluation Officer, Central Scotland Green Network Support Unit. E-mail: stephen.hughes@centralscotlandgreennetwork.org

For further information on other case studies please visit: www.centralscotlandgreennetwork.org